

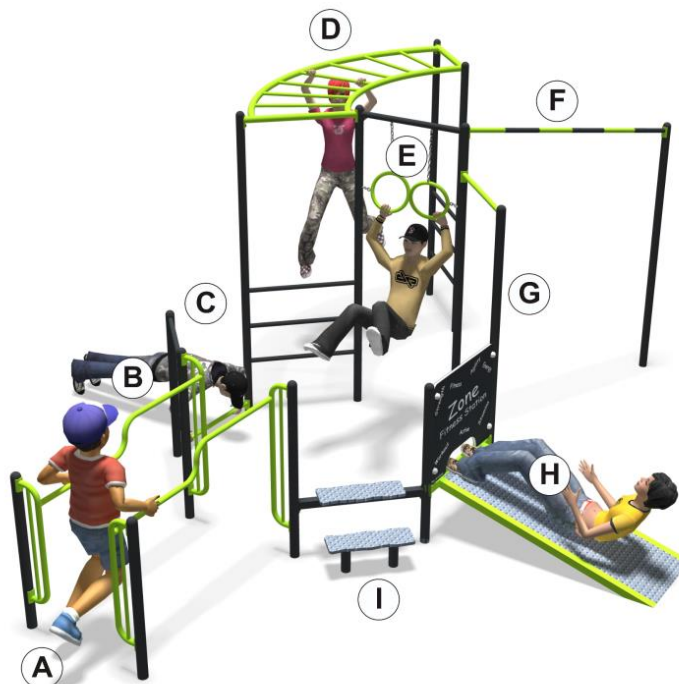
# Play & Leisure Ltd

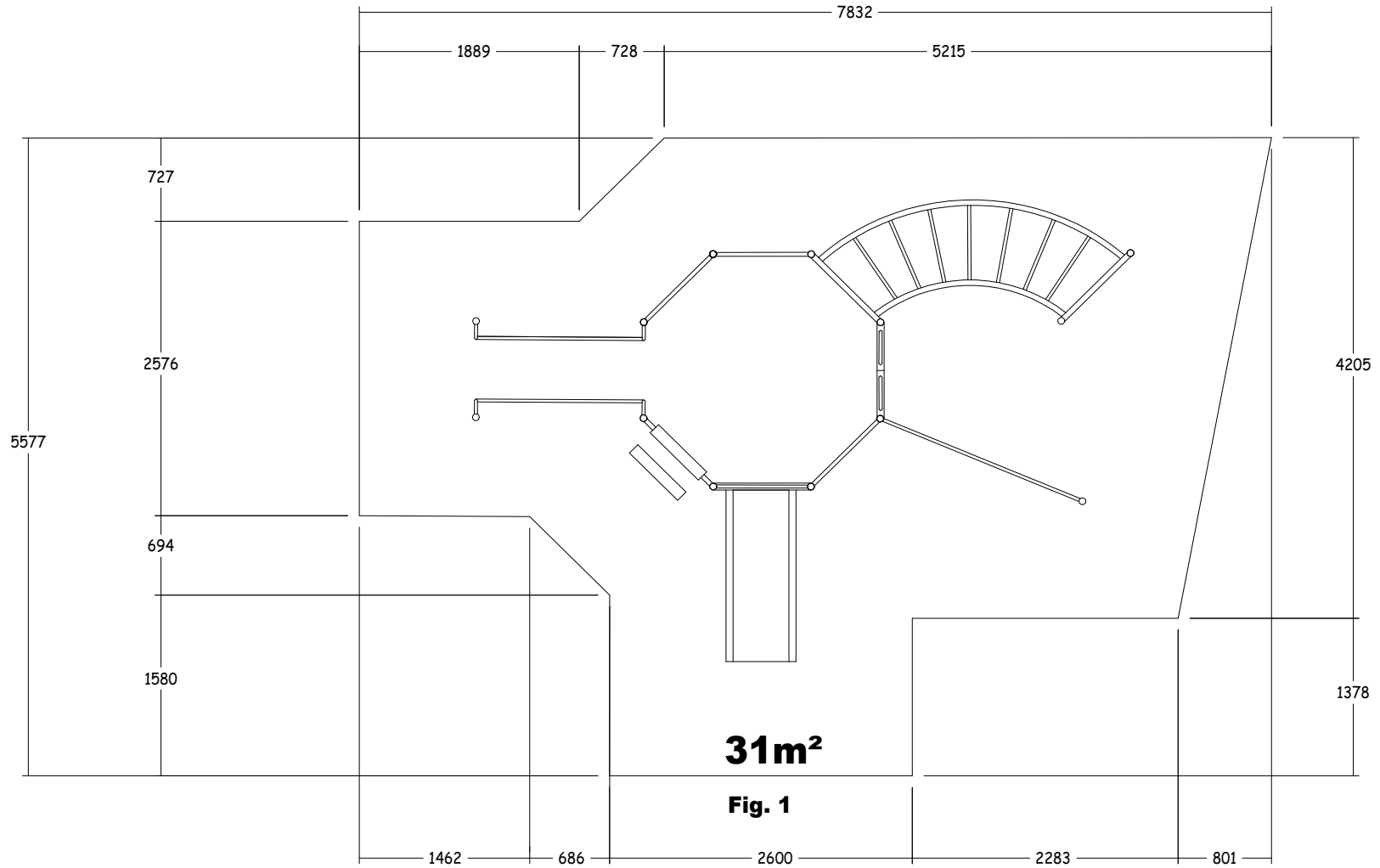
## Installation Details For Zone Fitness – Fitness Station (FZ15)

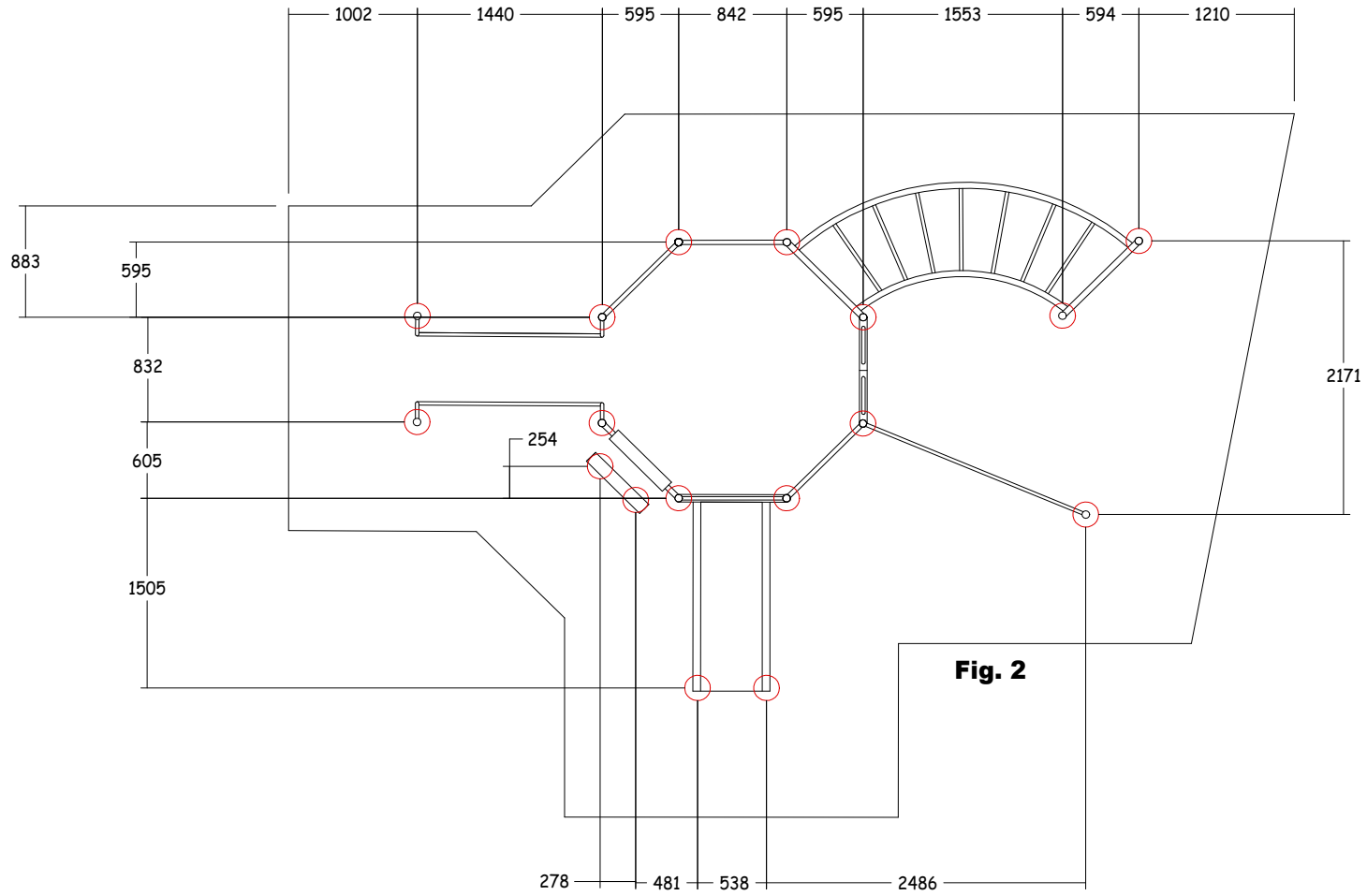
<u>Product List</u>		<u>Quantity</u>
Parallel Bars	(A)	1
Twizzy Bars	(B)	1
Push Up Bars	(C)	1
Overhead Ladders	(D)	1
Trapeze Rings	(E)	1
Jump Bar	(F)	1
Pull Up Bars	(G)	1
Sit Up Bench	(H)	1
Step Up	(I)	1

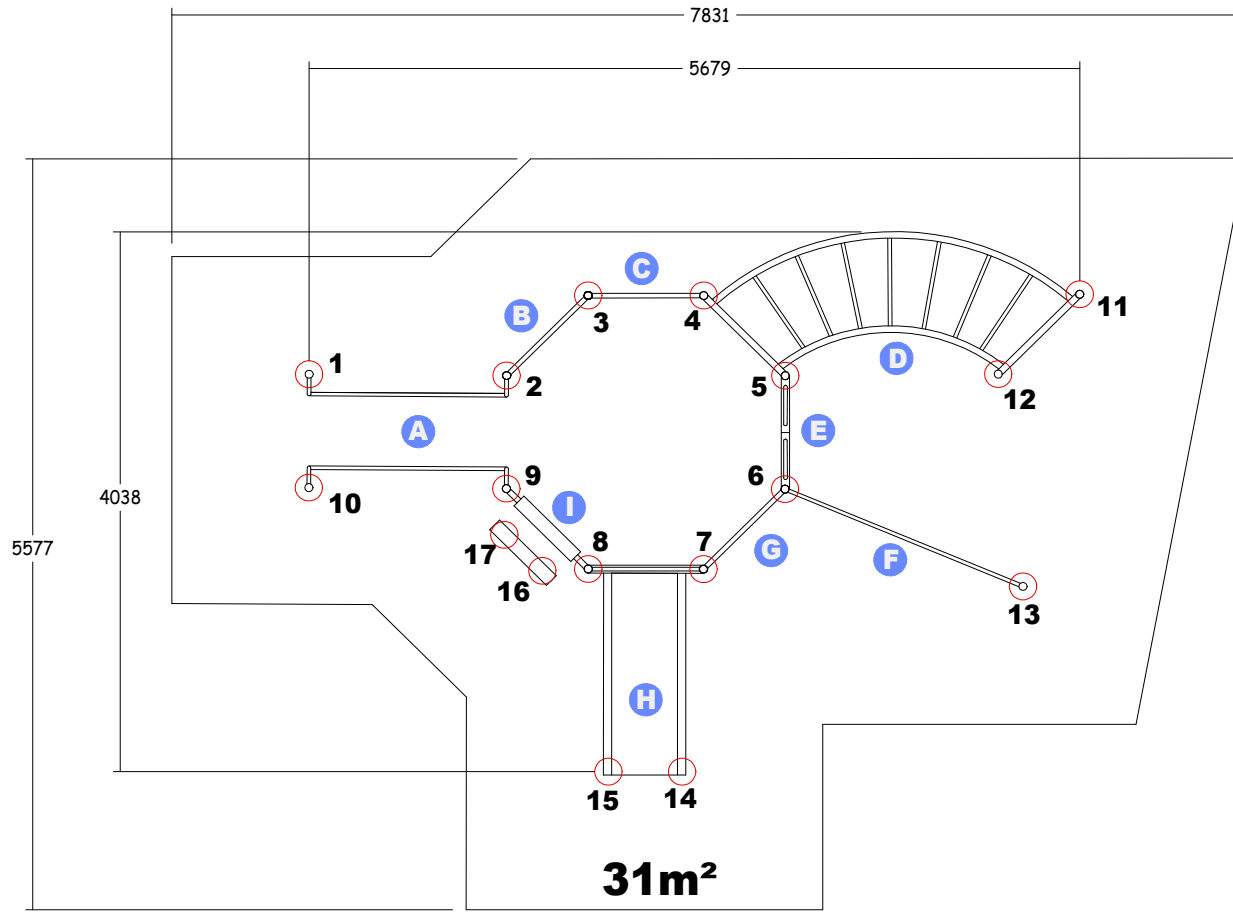
- 1 Construct base as per layout drawing 1 ensuring the correct levels for safety surfacing.
- 2 Excavate holes 1-12 & 14-17 as per drawing 2 (**All Posts have finished ground level marks**)
- 3 Excavate hole 13 as per drawing 2
- 4 Position the Posts as per drawing 3 – all posts are numbered. (**Tap holes with a 10mm tap and make sure bolts are only hand tight at this stage**)
- 5 Fit the Posts in to the excavated holes and connect together using the various components with M10 x 30 resistorx & nylon washers as drawing 3 and the attached visual
- 6 When installing the Sit Up Panel to the posts use the M10 x 50 resistorx bolts & plastic caps
- 7 Connect all chains using quick links & vandal pins
- 8 Once all equipment is fitted check levels again, tighten all bolts and concrete into the ground

**Note: Do not leave unattended until satisfied the concrete has cured or the site is secure**

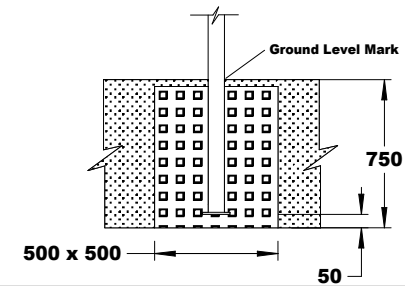
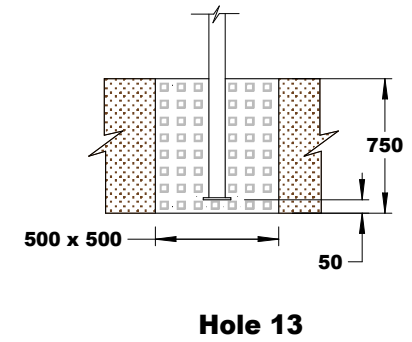
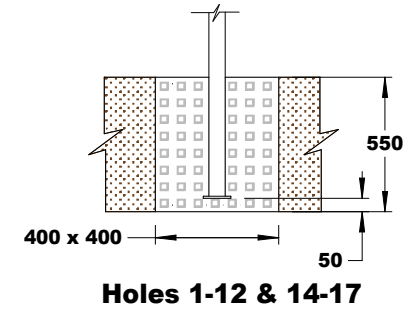






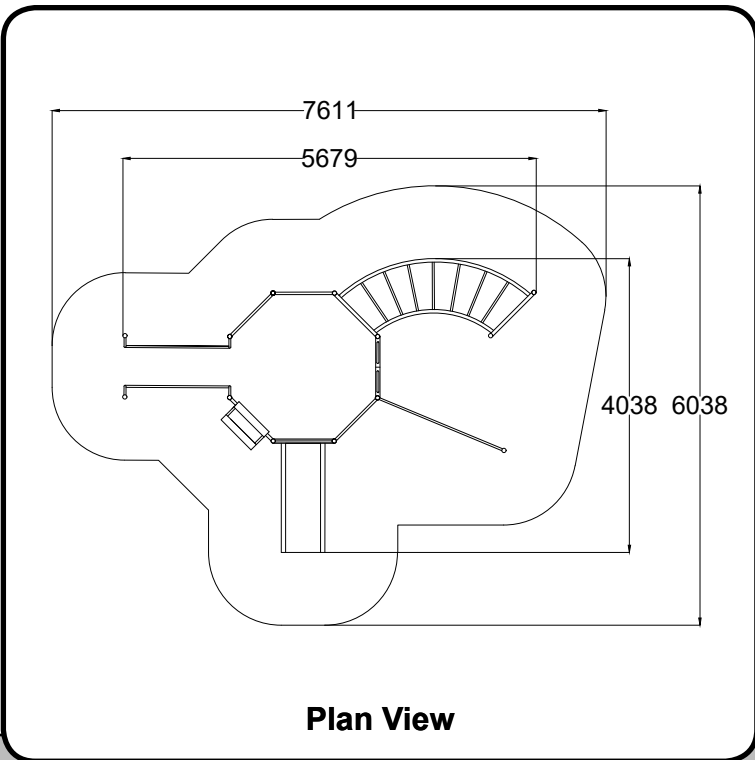


**Fig. 3**






**All Play & Leisure's product range is fully compliant with BS EN 16630**



### Technical Information

<b>Product Code</b>	FZ15
<b>Equipment Size</b>	5679L x 4038W x 2300H
<b>Minimum Space</b>	7611 x 6038
<b>Exercise Type</b>	Strength, Stretch, Cardio & Toning
<b>Main Features</b>	Overhead Ladder, Chin Up Bars, Parallel Bars, Push Up Bars, Sit Up Bench, Step Up Bench, Warm Up, Trapeze Rings, Jump Bar

# Play & Leisure Ltd

## Maintenance Schedule

### **Maintenance & Inspection**

All Play & Leisure's products should be inspected and maintained in accordance with the recommendations as detailed in BS EN 1176-7:2008

If any part of the equipment is found to be unsafe during an inspection and cannot be immediately rectified the equipment should be protected against further use.

### **Routine Visual Inspection.**

Routine visual inspections are to be conducted to identify obvious hazards resulting from vandalism, use or weather conditions. e.g. Hazards such as broken parts or broken bottles.

### **Operational Inspection.**

To reduce accidents the operator should ensure an appropriate routine maintenance schedule is established, implemented and maintained. Inspection shall be carried out on a monthly basis, although consideration should be taken regarding local conditions and usage.

During a operational inspection the following should be included:

- Tightening of fastenings.
- Re-painting and re-treatment of surfaces.
- Maintenance of any impact attenuating surfaces.
- Lubrication of bearings.
- Marking of equipment to signify loose fill finished surface levels.
- Cleaning.
- Removal of broken glass and other debris or contaminants.
- Restoring loose fills to the correct level.
- Maintenance of free space areas.

### **Annual Main Inspection (NOT EXCEEDING 12 MONTHS)**

Inspection intended to establish the overall level of safety of equipment, foundation and playing surfaces.

- Effects of weather.
- Rotting or corrosion.
- A change in the level of safety of the equipment as a result of repairs made, or of added or replaced components

### **One Post Equipment Maintenance.**

Special attention should be paid to the stability of products being of a one post design.

### **Corrective Maintenance.**

Corrective maintenance should include measures to correct defects, or to establish the necessary levels of safety of the playground equipment and surfaces. Such measures should include:

- Replacement of fastenings.
- Welding or welding repairs.
- Replacement of worn or defective parts.
- Replacement of defective structural components.

### **Equipment Alterations.**

Alterations to parts of any products that could affect the essential safety of the equipment should only be carried out after consultation with Play and Leisure.

### **Equipment Identification**

Information regarding the manufacturer, I.D. Number, year of manufacturer and the European Standard is displayed on an identification plaque.