

# FSCURVSS - Curve Spring Seesaw Installation Guide

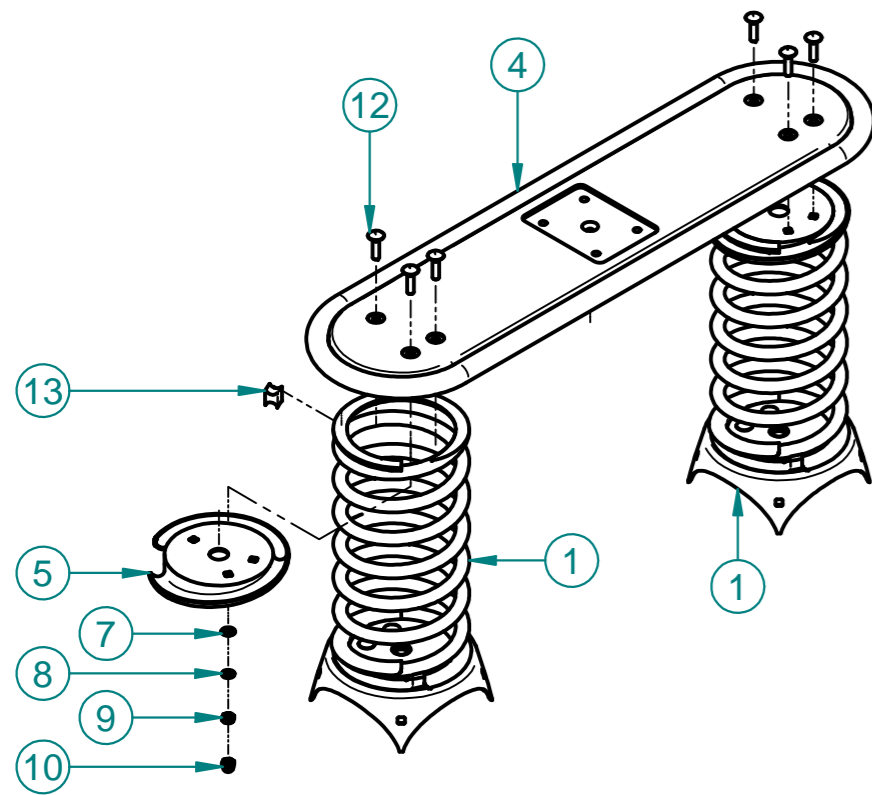

1. Position Spring Mounting Plate & Spacer correctly (see fig. 1).
2. Attach the two semi-assembled springs to the Seesaw Cross Section as above. ENSURE THESE FIXINGS ARE SUFFICIENTLY TIGHT & SECURE.

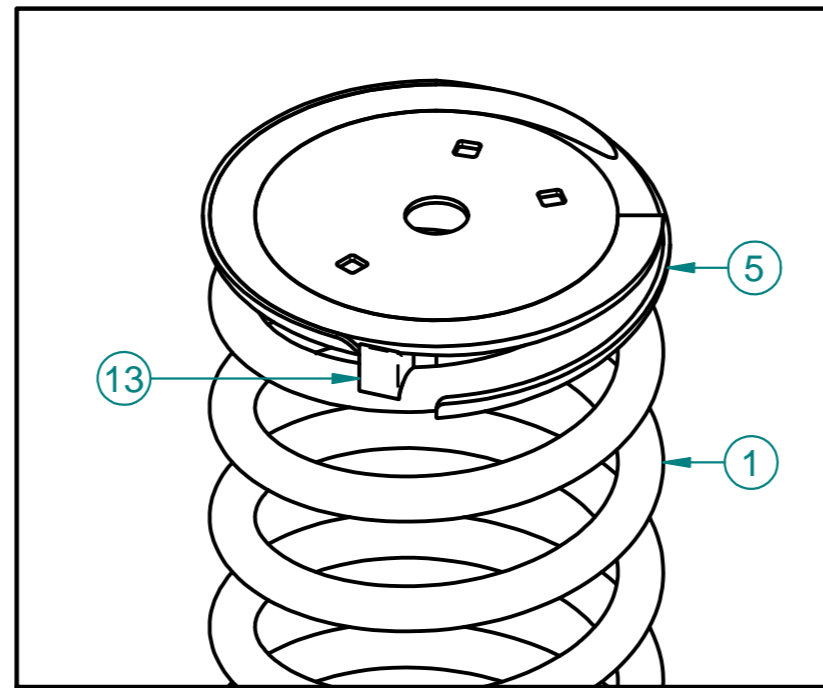
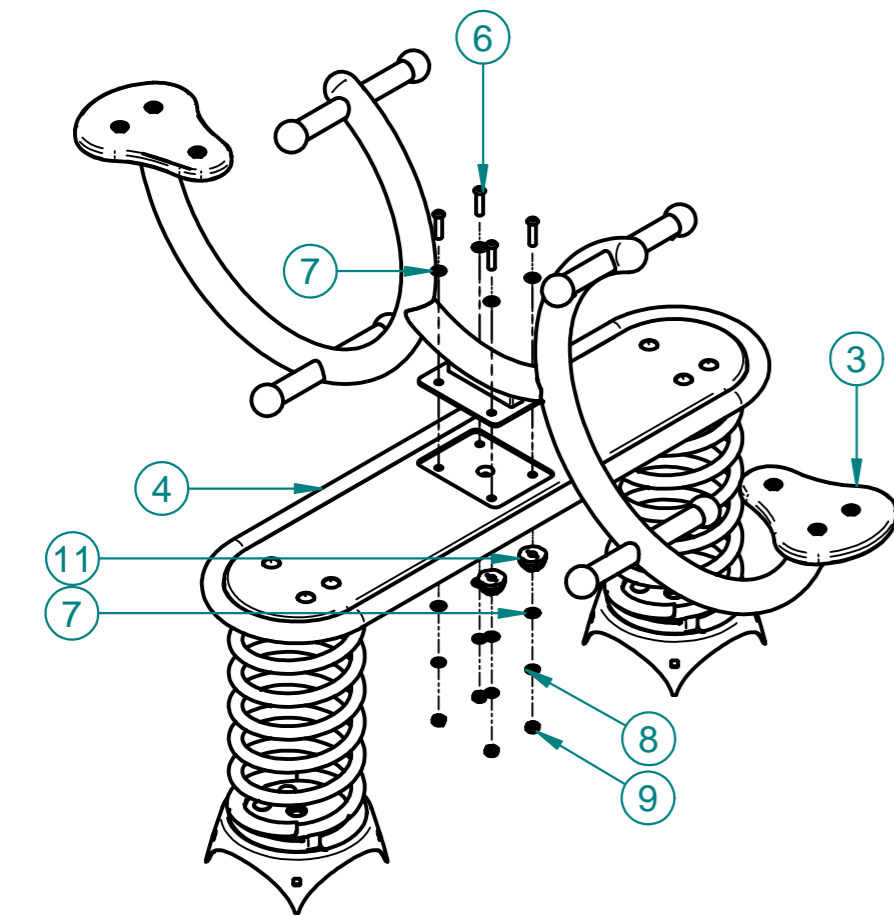

fig. 1

Before positioning Spring Mounting Plate, place the Spring Spacer in situ as shown above. Ensure Spring Mounting Plate is then sitting correctly before securing to Spring Beam Section.



3. Bolt the Seesaw Frame Assembly to the Body Section Assembly using fixings shown.

4. Assemble Ground Anchors and bolt to the bottom bracket of the pre-assembled springs.

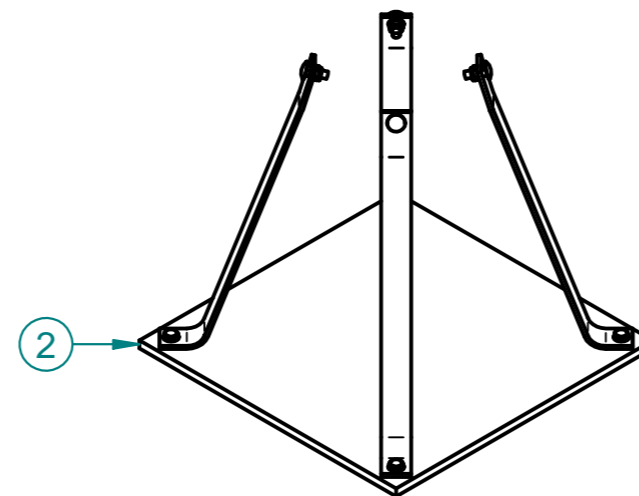

Ground Anchor kit supplied as loose components with fixing pack and instructions.

Please refer to document:  
FI-GA-GI-2013-A EGA Ground Anchor Installation Guide for specific footing details.

## Parts List

Item	Code	Description	Qty
1		400mm Spring Assembly - HD	2
2		Ground Anchor Kit	2
3		Curve Spring Seesaw Frame Assembly	1
4		Curve Seesaw Beam Assembly	1
5	FME0047-A	Spring Mounting Plate - HD	2
6	FSU0003-A	M10 x 40mm Button Head Bolt - SS	4
7	FSU0031-A	M10 Washer - SS	14
8	FSU0096-A	M10 Locking Washer - SS	10
9	FSU0097-A	M10 Plain Nut - SS	10
10	FSU0098-A	M10 Dome Nut - SS	6
11	FSU0100-A	M10 Two Piece Security Cap - Flower	4
12	FSU0172-A	M10 x 40mm Coach Bolt - SS	6
13	FSU0602-A	Spring Spacer - HD - 20 x 25 x 18.5	2

This product should be inspected by a competent person who is familiar with BS EN 1176 to the below maintenance and inspection schedule.

## Maintenance Inspection

FREQUENCY	WHAT TO DO
VISUAL INSPECTION (EVERY MONTH)	Identify any risks stemming from vandalism, intensive use or unusual weather
	Check for missing or broken parts
	Make sure that all protective covers are in place
FUNCTIONALITY INSPECTION (EVERY MONTH)	Inspect surfacing below and around equipment
	Check that the equipment, or the part concerned is operating correctly
	Check all fixings, joints and stability of the equipment and tighten or replace if necessary
COMPREHENSIVE INSPECTION (EVERY 6 MONTHS)	Check all parts for wear and tear and replace if necessary
	Thorough cleaning of equipment and any stainless steel parts with water and detergent
	All of the above plus:
	Inspect the anchoring system
COMPREHENSIVE INSPECTION (EVERY 6 MONTHS)	Inspect any moving, mechanical and electrical parts are operating correctly
	Check overall condition of any paintwork or galvanizing – repaint / touch up if necessary

**Surfacing Area: 17.6 sqm**  
**Free Height of Fall: 0.79m**

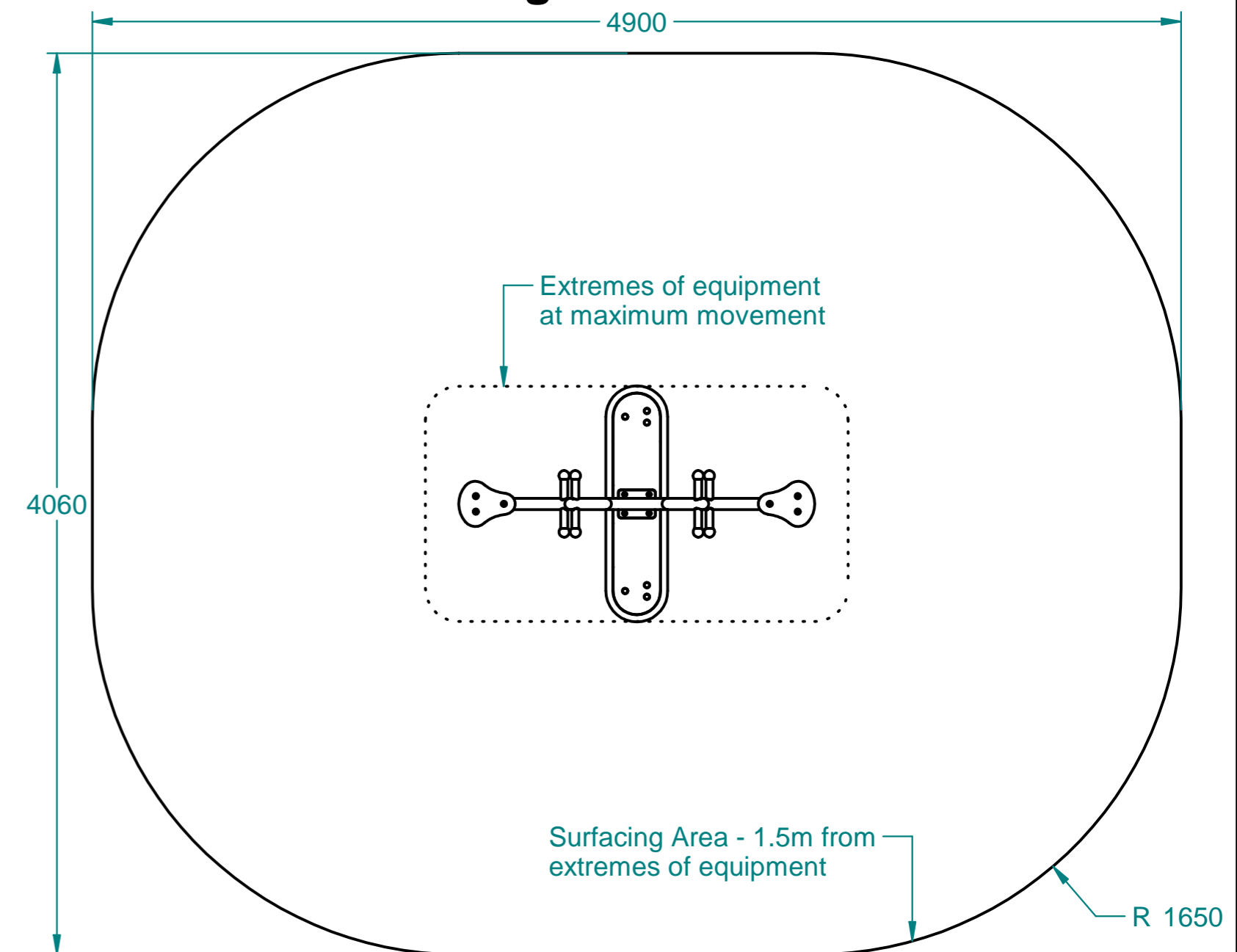

Approx. Unit Weight: 67.5kg

Seesaw Seat Assembly: 14kg  
Seesaw Cross Section Assembly: 11.5kg  
Spring Assembly: 18kg  
Ground Anchor Kit: 3kg

Modification	Date	Approved
New Drawing	27/04/16	RW
Updated Components	01/08/16	RW
FFH, Annotation Corrected	11/01/17	RW

Spitfire Road, Old Sarum, Salisbury  
Wiltshire, SP4 6GB, UK  
Tel: +44 (0)1722 349 793  
www.fahr-industries.com

**Fahr Industries Ltd**

This document, including the copyright therein, is the property of Fahr Industries Ltd and may not be utilised for any purpose or reproduced, or transmitted to any third party without prior written consent.

⊕	All Dimensions in mm	1 of 1	Not To Scale
DrG By	Richard Willstrop	Date	27/04/16

# SEESAWS - Curve Spring *ESS60*

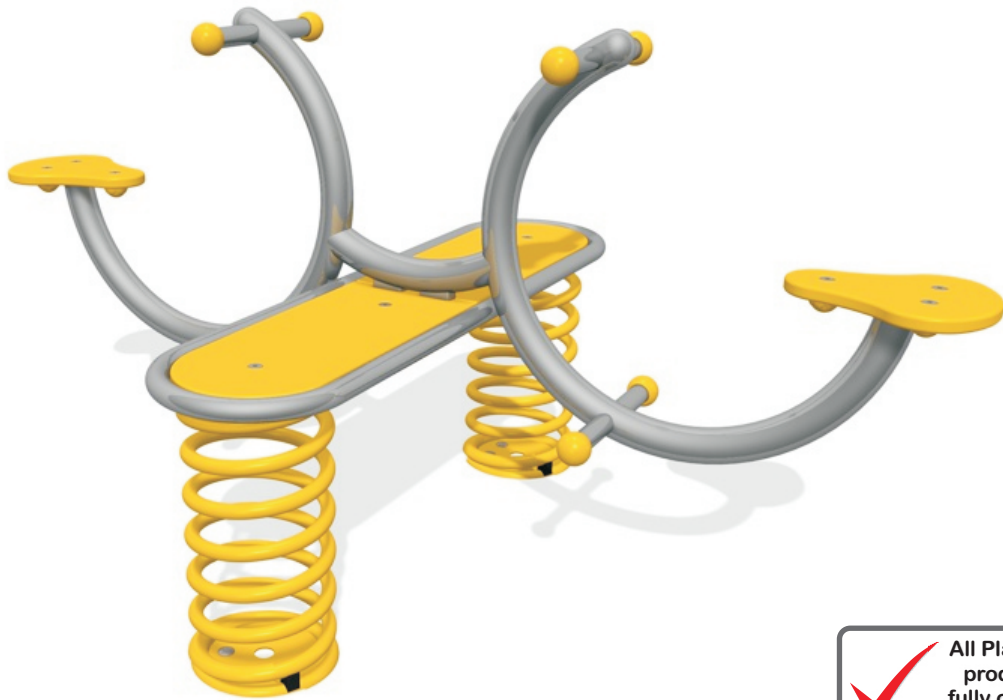

✓ All Play & Leisure's product range is fully compliant with **BS EN 1176:2008**

## Technical AT-A-GLANCE

Product Code	<i>ESS60</i>
Equipment Size	1603L x 1064W x 832H
Minimum Space	4603 x 4064
Free Height of Fall	787
Safety Surface Area	18m <sup>2</sup>

Side Elevation

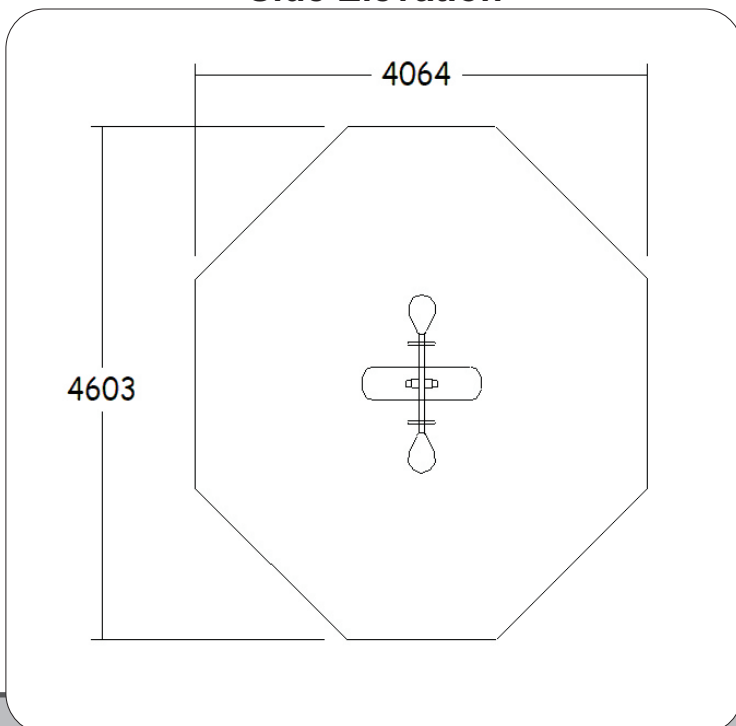

# Maintenance Schedule

## **Maintenance & Inspection**

All Play & Leisure's products should be inspected and maintained in accordance with the recommendations as detailed in BS EN 1176-7:2008

If any part of the equipment is found to be unsafe during an inspection and cannot be immediately rectified the equipment should be protected against further use.

## **Routine Visual Inspection.**

Routine visual inspections are to be conducted to identify obvious hazards resulting from vandalism, use or weather conditions. e.g. Hazards such as broken parts or broken bottles.

## **Operational Inspection.**

To reduce accidents the operator should ensure an appropriate routine maintenance schedule is established, implemented and maintained. Inspection shall be carried out on a monthly basis, although consideration should be taken regarding local conditions and usage.

During a operational inspection the following should be included:

- Tightening of fastenings.
- Re-painting and re-treatment of surfaces.
- Maintenance of any impact attenuating surfaces.
- Lubrication of bearings.
- Marking of equipment to signify loose fill finished surface levels.
- Cleaning.
- Removal of broken glass and other debris or contaminants.
- Restoring loose fills to the correct level.
- Maintenance of free space areas.

## **Annual Main Inspection (NOT EXCEEDING 12 MONTHS)**

Inspection intended to establish the overall level of safety of equipment, foundation and playing surfaces.

- Effects of weather.
- Rotting or corrosion.
- A change in the level of safety of the equipment as a result of repairs made, or of added or replaced components

## **One Post Equipment Maintenance.**

Special attention should be paid to the stability of products being of a one post design.

## **Corrective Maintenance.**

Corrective maintenance should include measures to correct defects, or to establish the necessary levels of safety of the playground equipment and surfaces. Such measures should include:

- Replacement of fastenings.
- Welding or welding repairs.
- Replacement of worn or defective parts.
- Replacement of defective structural components.

## **Equipment Alterations.**

Alterations to parts of any products that could affect the essential safety of the equipment should only be carried out after consultation with Play and Leisure.

## **Equipment Identification**

Information regarding the manufacturer, I.D. Number, year of manufacturer and the European Standard is displayed on an identification plaque.