

# FSSSOCT - Olivia the Octopus Spring Seesaw - Installation Instructions

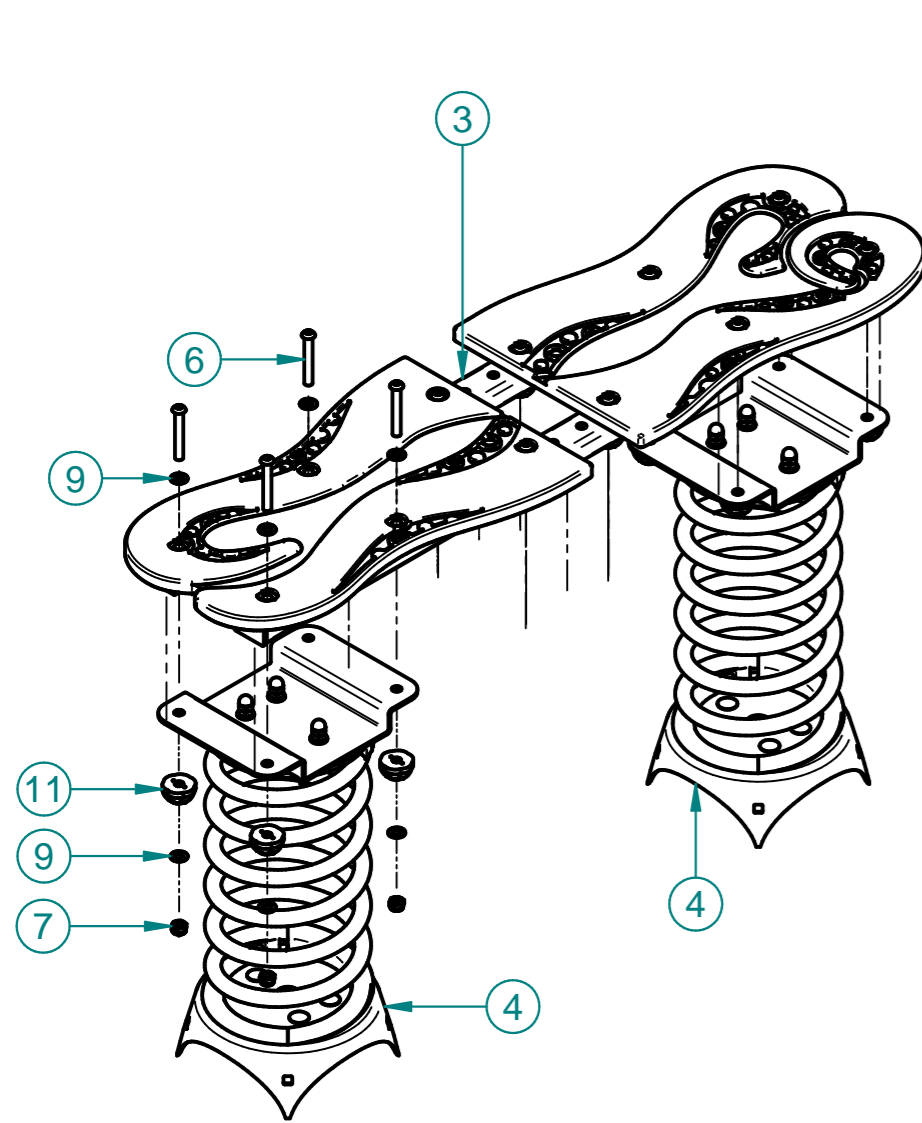

1. Attach the two pre-assembled springs to the Seesaw Cross Section Assembly.

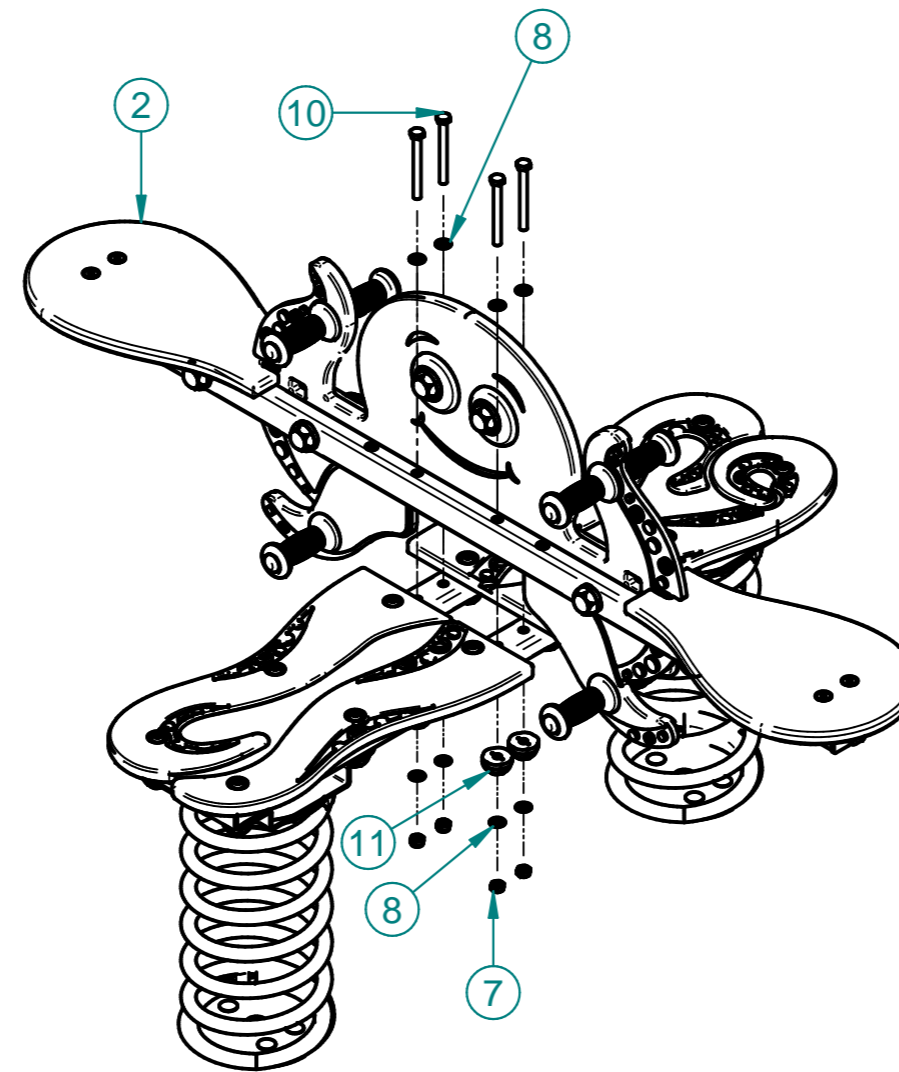

2. Bolt the Seesaw Seat Assembly to the Body Section Assembly using fixings shown.

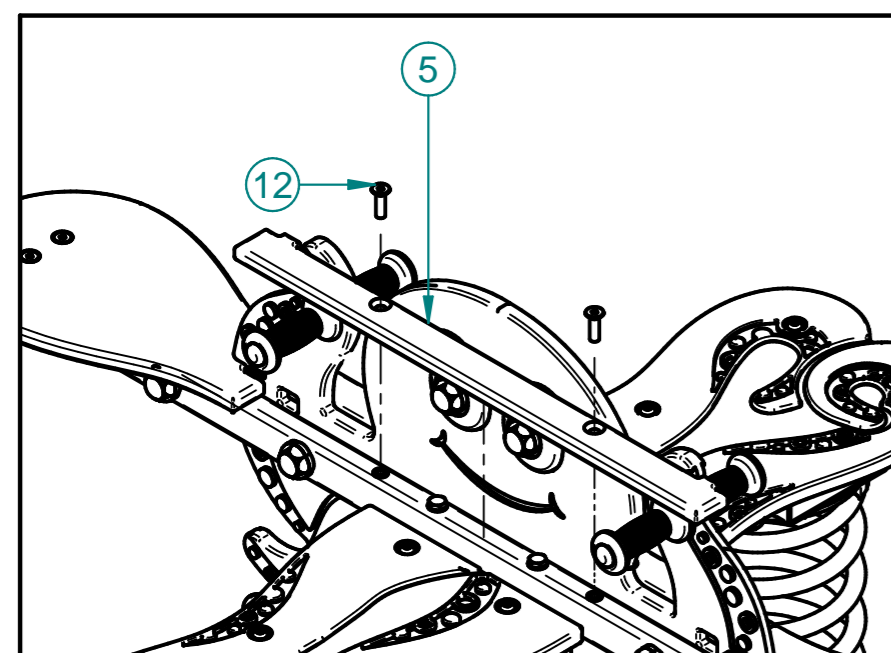

3. Bolt the 2x Jigsaw top covers over the Fixings used in step 2 as shown above.

## Foundation Excavation Details for Back-Fill

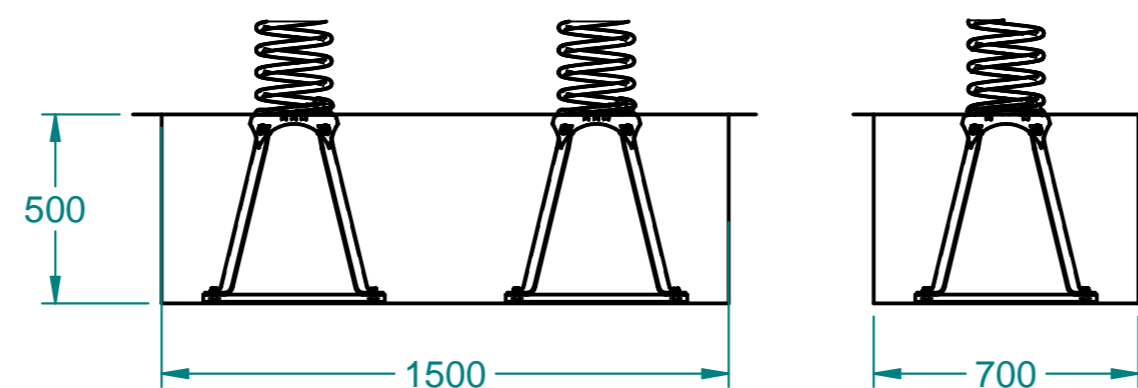

4. Assemble Ground Anchors and bolt to the bottom bracket of the pre-assembled springs.

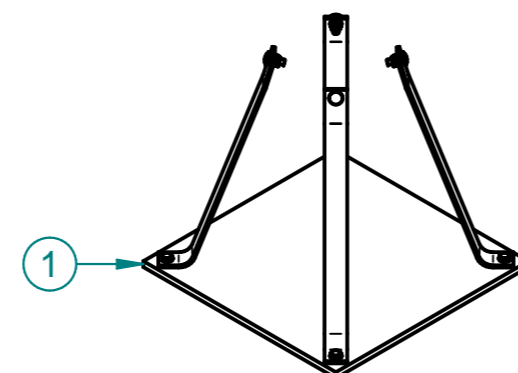

Ground Anchor kit supplied as loose components with fixing pack and instructions.

Please refer to document:  
FI-GA-GI-2013-A EGA Ground Anchor Installation Guide  
for specific footing details.

This product should be inspected by a competent person who is familiar with BS EN 1176 to the below maintenance and inspection schedule.

## Maintenance Inspection

| FREQUENCY                                    | WHAT TO DO   |
|--|--|
| VISUAL INSPECTION<br>(EVERY MONTH)           | Identify any risks stemming from vandalism, intensive use or unusual weather   |
|  | Check for missing or broken parts  |
|  | Make sure that all protective covers are in place<br>Inspect surfacing below and around equipment  |
| FUNCTIONALITY INSPECTION<br>(EVERY MONTH)    | Check that the equipment, or the part concerned is operating correctly   |
|  | Check all fixings, joints and stability of the equipment and tighten or replace if necessary   |
|  | Check all parts for wear and tear and replace if necessary<br>Thorough cleaning of equipment and any stainless steel parts with water and detergent                      |
| COMPREHENSIVE INSPECTION<br>(EVERY 6 MONTHS) | All of the above plus:   |
|  | Inspect the anchoring system   |
|  | Inspect any moving, mechanical and electrical parts are operating correctly<br>Check overall condition of any paintwork or galvanizing – repaint / touch up if necessary |

**Surface Area: 17.85 sqm**  
**Free Height of Fall: 0.78m**

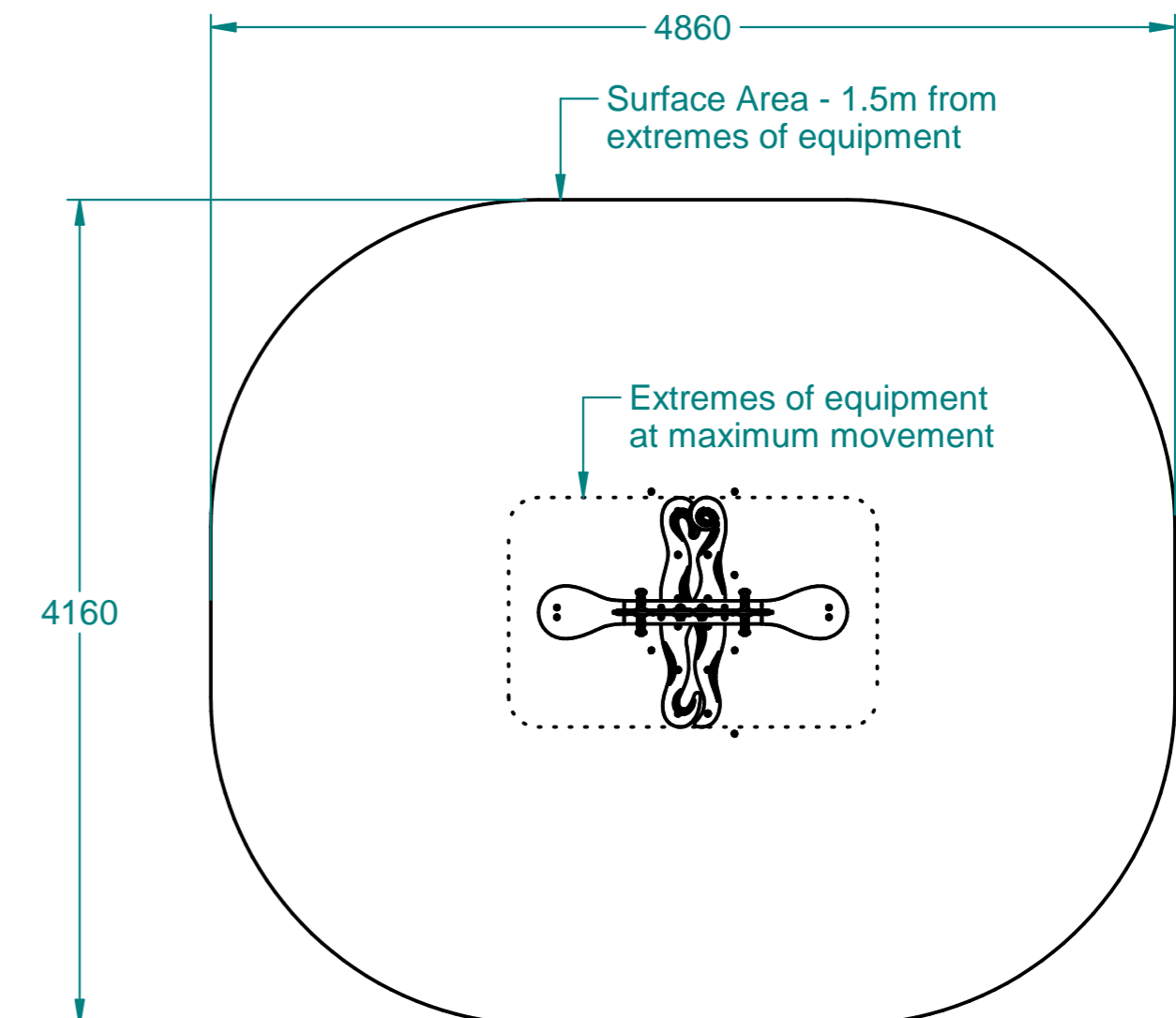

## Parts List

| Item | Code      | Description                         | Qty |
|------|-----------|-------------------------------------|-----|
| 1    |           | Ground Anchor Kit                   | 2   |
| 2    |           | Seesaw Body/Seat Assembly           | 1   |
| 3    |           | Seesaw Tentacles/Beam Assembly      | 1   |
| 4    |           | Spring Assembly - 400mm HD          | 2   |
| 5    | FPL2795-B | Seesaw Centre Strip                 | 2   |
| 6    | FSU0006-A | M10 x 70mm Button Head Bolt - SS    | 8   |
| 7    | FSU0009-A | M10 Nylock Nut - ZP                 | 12  |
| 8    | FSU0014-A | M10 Washer - ZP                     | 8   |
| 9    | FSU0031-A | M10 Washer - SS                     | 16  |
| 10   | FSU0099-A | M10 x 100mm Hex Head Bolt - ZP      | 4   |
| 11   | FSU0100-A | M10 Two Piece Security Cap - Flower | 12  |
| 12   | FSU0197-A | M10 x 35mm CSK Bolt - SS            | 4   |



Approx. Unit Weight: 80kg

Seesaw Seat Assembly: 22kg  
Seesaw Cross Section Assembly: 12kg  
Spring Assembly: 20kg  
Ground Anchor Kit: 3kg

| Modification            | Date     | Approved |
|-------------------------|----------|----------|
| New Drawing             | 27/04/16 | RW       |
| Updated Components      | 02/03/17 | RW       |
| Foundation Detail Added | 20/04/17 | RW       |

Spitfire Road, Old Sarum, Salisbury  
Wiltshire, SP4 6GB, UK  
Tel: +44 (0)1722 349 793  
www.fahr-industries.com

**Fahr Industries Ltd**

This document, including the copyright therein, is the property of Fahr Industries Ltd and may not be utilised for any purpose or reproduced, or transmitted to any third party without prior written consent.

|        |                      |        |              |
|--------|----------------------|--------|--------------|
| ⊕      | All Dimensions in mm | 1 of 1 | Not To Scale |
| DrG By | Richard Willstrop    | Date   | 28/01/2015   |